

Brass Back Pressure Regulator, up to 65 bar

DBM

Description	Back pressure regulators protect pneumatic devices against overpressure. If the pressure exceeds the setpoint, the pressure valve exhausts to the atmosphere until the pressure level is below the setpoint. It is advisable to select the pressure range as near as possible to the maximum setpoint.	
Media	compressed air, non-corrosive gases or liquids	
Overpressure	see chart, max. 65 bar	
Adjustment	by spindle with locknut	for DBM-01
	by black plastic knob with snap-lock	for DBM-02
	by T-handle with locknut	for DBM-04 / -08
	by hexagonal spindle (spanner size 24 mm) with locknut	for DBC-12 / -16
Gauge port	G $\frac{1}{8}$ at DBM-01 on both sides of the body, G $\frac{1}{4}$ from DBC-02 on, screw plugs supplied	
Temperature range	0 °C to 60 °C / 32 °F to 140 °F, optionally high temperature version up to 130 °C / 266 °F	
Material	Body: brass	O-rings: NBR/Buna-N, optionally FKM or EPDM
	Inner valve: brass	Diaphragm: NBR/Buna-N with PTFE coating

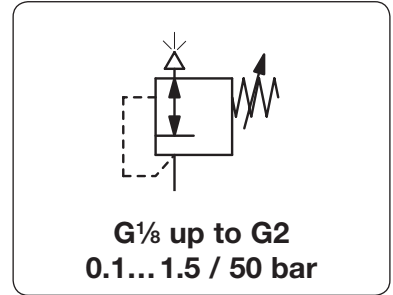

Dimensions			Reg. system	Relief capacity	Over-pressure	Connection thread	Adjustment range	Order number
A	B	C	D: diaphragm P: piston	l/min*1	max. bar	G	bar	

Brass back pressure regulator overpressure max. 30/65 bar								DBM			
40	82	10	D	200	30	G $\frac{1}{8}$	0.1 ... 1.5	DBM-01A			
							0.2 ... 3.0	DBM-01B			
							0.5 ... 8.0	DBM-01D			
							1.0 ... 15	DBM-01E			
78	157	33	D	300	30	G $\frac{1}{4}$	0.1 ... 1.5	DBM-02A			
							0.2 ... 3.0	DBM-02B			
							0.5 ... 8.0	DBM-02D			
			P				65	1.0 ... 15	DBM-02E		
								2.0 ... 30	DBM-02F		
								3.0 ... 50	DBM-02G		
82	167	38	D	1800	30	G $\frac{1}{2}$	0.1 ... 1.5	DBM-04A			
							0.2 ... 3.0	DBM-04B			
							0.5 ... 8.0	DBM-04D			
			P				65	1.0 ... 15	DBM-04E		
								2.0 ... 30	DBM-04F		
								3.0 ... 50	DBM-04G		
127	275	69	D	4000	30	G $\frac{3}{4}$	0.1 ... 1.5	DBM-A6A			
							0.2 ... 3.0	DBM-A6B			
							0.5 ... 8.0	DBM-A6D			
							1.0 ... 15	DBM-A6E			
			P			65	2.0 ... 30	DBM-A6F			
							3.0 ... 50	DBM-A6G			
							D	30	G1	0,1 ... 1.5	DBM-08A
										0,2 ... 3.0	DBM-08B
			0,5 ... 8.0			DBM-08D					
			1,0 ... 15			DBM-08E					
			P			65	G1	2,0 ... 30	DBM-08F		
								3,0 ... 50	DBM-08G		



DBM-02D



DBM-04D
accessory: gauge

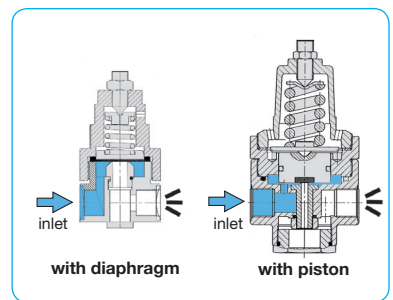
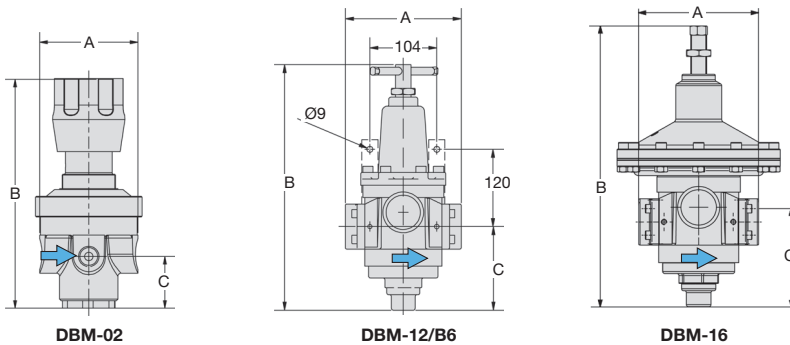
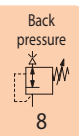

cross section

*1 at 7 bar overpressure and open outlet
*2 02 = 0...2.5 bar, 04 = 0...4 bar, 06 = 0...6 bar, 10 = 0...10 bar, 16 = 0...16 bar, 60 = 0...60 bar

Gauges: see chapter for measuring devices

PDF CAD
www.aircom.net



Order example:
DBM-01A

Description	Back pressure regulators protect pneumatic devices against overpressure. If the pressure exceeds the setpoint, the pressure valve exhausts to the atmosphere until the pressure level is below the setpoint. It is advisable to select the pressure range as near as possible to the maximum setpoint.		
Media	compressed air, non-corrosive gases or liquids		
Overpressure	see chart, max. 65 bar		
Adjustment	by spindle with locknut by black plastic knob with snap-lock by T-handle with locknut by hexagonal spindle (spanner size 24 mm)		for DBM-01 for DBM-02 for DBM-04 / -08 for DBM-12 / -16
Gauge port	G $\frac{1}{4}$ at DBM-01 on both sides of the body, G $\frac{1}{4}$ from DBC-02 on, screw plugs supplied		
Temperature range	0 °C to 60 °C / 32 °F to 140 °F, optionally high temperature version up to 130 °C / 266 °F		
Material	Body: brass Inner valve: brass	O-rings: NBR/Buna-N, optionally FKM or EPDM Diaphragm: NBR/Buna-N with PTFE coating	

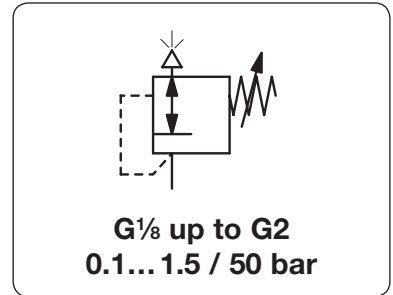

Dimensions			Reg. system	Relief capacity	Over-pressure	Connection thread	Adjustment range	Order number
A	B	C	D: diaphragm P: piston	l/min*1	max. bar	G	bar	

Brass back pressure regulator overpressure max. 30/65 bar								DBM
210	323	52	D	12 000	30	G1 $\frac{1}{2}$	0.1 ... 1.5	DBM-12A
							0.2 ... 3.0	DBM-12B
							0.5 ... 8.0	DBM-12D
							1.0 ... 15	DBM-12E
			P		65		2.0 ... 30	DBM-12F
							3.0 ... 50	DBM-12G
			D		30	G2	0.1 ... 1.5	DBM-16A
							0.2 ... 3.0	DBM-16B
							0.5 ... 8.0	DBM-16D
							1.0 ... 15	DBM-16E
			P		65		2.0 ... 30	DBM-16F
							3.0 ... 50	DBM-16G



DBM-08D

Special options, add the appropriate letter

NPT	connection thread	DBM-... N
up to 130 °C / 266 °F	high temperature version, up to DBM-04	DBM-... X54
FKM o-ring	PTFE diaphragm	DBM-... V
EPDM o-ring	PTFE diaphragm	DBM-... E
T-handle	instead of knob, DBM-02 only	DBM-02. T
flange connection	see chapter for stainless steel devices / flanges	DBM-... F.
nitrogen N $_2$: 07	carbon dioxide CO $_2$: 03	argon Ar: DBM-... 05
helium He: 09	hydrogen H $_2$: 11	methane CH $_4$: DBM-... 13
oxygen O $_2$: 15	propane C $_3$ H $_8$: 16	nitrous oxide N $_2$ O: DBM-... 17
	water	H $_2$ O: DBM-... W

Accessories, enclosed

pressure gauge	Ø 50 mm, 0...*2 bar, G $\frac{1}{4}$ on the back	for G $\frac{1}{4}$ and G $\frac{1}{2}$	MA5002-...*2
pressure gauge	Ø 63 mm, 0...*2 bar, G $\frac{1}{4}$ on the back	for G $\frac{3}{4}$ up to G2	MA6302-...*2
mounting bracket	made of stainless steel	for G $\frac{1}{4}$	BW35-01S
mounting nut	made of stainless steel	for G $\frac{1}{4}$	M35x1,5S
mounting bracket	made of stainless steel	for G $\frac{1}{2}$	BW50-01S
mounting nut	made of stainless steel	for G $\frac{1}{2}$	M50x1,5S
mounting bracket	made of steel	for G $\frac{3}{4}$ and G1	BW00-42
		for G1 $\frac{1}{2}$ and G2	BW00-43

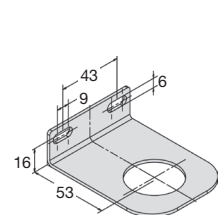

BW35-01S

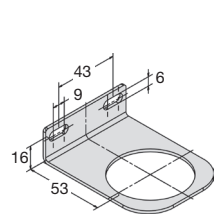

BW50-01S

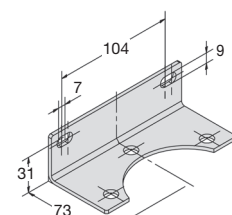

BW00-42

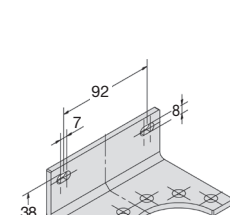

BW00-43

*1 at 7 bar overpressure and open outlet
*2 02 = 0...2.5 bar, 04 = 0...4 bar, 06 = 0...6 bar, 10 = 0...10 bar, 16 = 0...16 bar, 60 = 0...60 bar

Gauges: see chapter for measuring devices

PDF CAD
www.aircom.net



Order example:
DBM-12A

